

**SHAFT LEGENDS**

LV	LOW VOLTAGE CABLE SHAFT
ELEC.	ELECTRICAL SHAFT
PL	PLUMBING SHAFT
LLPS	LIFT LOBBY PRESSURISATION SHAFT
FHC	FIRE HOSE CABINET
COWSR	COLD WATER SUPPLY/RETURN
CHWSR	CHILLED WATER SUPPLY/RETURN
CDR. (FR)	CORRIDOR EXHAUST
CDR. (EX)	CORRIDOR FRESH AIR
SPL. KIT. (EX)	SPECIALITY KITCHEN EXHAUST
TOI. (EX)	TOILET EXHAUST
ST (PR)	STAIRCASE PRESSURISATION SHAFT
PAN (EX)	PANTRY EXHAUST
STP (EX)	STP EXHAUST
DIS. KIT. (EX)	DISPLAY KITCHEN EXHAUST
KIT. TFA	KITCHEN TREATED FRESH AIR
KITCHEN (SR)	KITCHEN (SUPPLY/RETURN AIR)
HOTEL BOH (EX.)	HOTEL BOH EXHAUST
KIT. (EX)	KITCHEN EXHAUST

**REFUGE AREA CALCULATION**

CINEMA & OFFICE BLOCK	
POPULATION AT SIXTH FLOOR	0 PERSON
POPULATION AT SEVENTH FLOOR	197 PERSON
TOTAL POPULATION @OFFICE FLOOR	197 PERSON
REFUGE AREA REQUIRED @0.3 SQM/PERSON	59.1315 SQM
REFUGE AREA PROVIDED	113.17 SQM

HOTEL BLOCK	
POPULATION AT SIXTH FLOOR	414 PERSON
POPULATION AT SEVENTH FLOOR	112 PERSON
TOTAL POPULATION @HOTEL FLOOR	525 PERSON
REFUGE AREA REQUIRED @0.3 SQM/PERSON	157.65 SQM
REFUGE AREA PROVIDED	160.5 SQM

- PROJECT CODE : 198 - 2021
- This Drawing and Design is the Property of the Designers, no portion may be used or Reproduced without their Written Permission.
  - All Dimensions are to be Verified onsite by the Contractor. Any Discrepancies are to be Reported to the Designers Immediately.
  - This Drawing is to be Read in Conjunction with the Designers Specifications, Conditions of Contract and Relevant Consultant Drawings.
  - Drawings not Showing the Listed Revisions are to be Cancelled.
  - All Dimensions are to be Read as Indicated.
  - All Indicated Levels are to be Read as Indicated unless Noted Otherwise.
  - Architect is not responsible for any deviation in areas (Build, structure, marking etc.).
  - Any and All deviations from original drawings is understood to be made at client's request with prior information provided to the client by architect about legal implications. Architect is not responsible for any deviations (can be held responsible for such deviations).

**DOORS WINDOW SCHEDULE**

DOORS	
TYPE	SIZE (MM)
D1	2000 X 900
D2	2000 X 900
D3	2000 X 900
D4	2000 X 900
D5	2000 X 900
D6	2000 X 900
D7	2000 X 900
D8	2000 X 900
D9	2000 X 900
D10	2000 X 900
D11	2000 X 900
D12	2000 X 900
D13	2000 X 900
D14	2000 X 900
D15	2000 X 900
D16	2000 X 900
D17	2000 X 900
D18	2000 X 900
D19	2000 X 900
D20	2000 X 900
D21	2000 X 900
D22	2000 X 900
D23	2000 X 900
D24	2000 X 900
D25	2000 X 900
D26	2000 X 900
D27	2000 X 900
D28	2000 X 900
D29	2000 X 900
D30	2000 X 900
D31	2000 X 900
D32	2000 X 900
D33	2000 X 900
D34	2000 X 900
D35	2000 X 900
D36	2000 X 900
D37	2000 X 900
D38	2000 X 900
D39	2000 X 900
D40	2000 X 900
D41	2000 X 900
D42	2000 X 900
D43	2000 X 900
D44	2000 X 900
D45	2000 X 900
D46	2000 X 900
D47	2000 X 900
D48	2000 X 900
D49	2000 X 900
D50	2000 X 900
D51	2000 X 900
D52	2000 X 900
D53	2000 X 900
D54	2000 X 900
D55	2000 X 900
D56	2000 X 900
D57	2000 X 900
D58	2000 X 900
D59	2000 X 900
D60	2000 X 900
D61	2000 X 900
D62	2000 X 900
D63	2000 X 900
D64	2000 X 900
D65	2000 X 900
D66	2000 X 900
D67	2000 X 900
D68	2000 X 900
D69	2000 X 900
D70	2000 X 900
D71	2000 X 900
D72	2000 X 900
D73	2000 X 900
D74	2000 X 900
D75	2000 X 900
D76	2000 X 900
D77	2000 X 900
D78	2000 X 900
D79	2000 X 900
D80	2000 X 900
D81	2000 X 900
D82	2000 X 900
D83	2000 X 900
D84	2000 X 900
D85	2000 X 900
D86	2000 X 900
D87	2000 X 900
D88	2000 X 900
D89	2000 X 900
D90	2000 X 900
D91	2000 X 900
D92	2000 X 900
D93	2000 X 900
D94	2000 X 900
D95	2000 X 900
D96	2000 X 900
D97	2000 X 900
D98	2000 X 900
D99	2000 X 900
D100	2000 X 900
D101	2000 X 900
D102	2000 X 900
D103	2000 X 900
D104	2000 X 900
D105	2000 X 900
D106	2000 X 900
D107	2000 X 900
D108	2000 X 900
D109	2000 X 900
D110	2000 X 900
D111	2000 X 900
D112	2000 X 900
D113	2000 X 900
D114	2000 X 900
D115	2000 X 900
D116	2000 X 900
D117	2000 X 900
D118	2000 X 900
D119	2000 X 900
D120	2000 X 900
D121	2000 X 900
D122	2000 X 900
D123	2000 X 900
D124	2000 X 900
D125	2000 X 900
D126	2000 X 900
D127	2000 X 900
D128	2000 X 900
D129	2000 X 900
D130	2000 X 900
D131	2000 X 900
D132	2000 X 900
D133	2000 X 900
D134	2000 X 900
D135	2000 X 900
D136	2000 X 900
D137	2000 X 900
D138	2000 X 900
D139	2000 X 900
D140	2000 X 900
D141	2000 X 900
D142	2000 X 900
D143	2000 X 900
D144	2000 X 900
D145	2000 X 900
D146	2000 X 900
D147	2000 X 900
D148	2000 X 900
D149	2000 X 900
D150	2000 X 900
D151	2000 X 900
D152	2000 X 900
D153	2000 X 900
D154	2000 X 900
D155	2000 X 900
D156	2000 X 900
D157	2000 X 900
D158	2000 X 900
D159	2000 X 900
D160	2000 X 900
D161	2000 X 900
D162	2000 X 900
D163	2000 X 900
D164	2000 X 900
D165	2000 X 900
D166	2000 X 900
D167	2000 X 900
D168	2000 X 900
D169	2000 X 900
D170	2000 X 900
D171	2000 X 900
D172	2000 X 900
D173	2000 X 900
D174	2000 X 900
D175	2000 X 900
D176	2000 X 900
D177	2000 X 900
D178	2000 X 900
D179	2000 X 900
D180	2000 X 900
D181	2000 X 900
D182	2000 X 900
D183	2000 X 900
D184	2000 X 900
D185	2000 X 900
D186	2000 X 900
D187	2000 X 900
D188	2000 X 900
D189	2000 X 900
D190	2000 X 900
D191	2000 X 900
D192	2000 X 900
D193	2000 X 900
D194	2000 X 900
D195	2000 X 900
D196	2000 X 900
D197	2000 X 900
D198	2000 X 900
D199	2000 X 900
D200	2000 X 900

**AREA STATEMENT**

TOTAL F.A.R ON SIXTH FLOOR	1917.29 SQM.
----------------------------	--------------

**SPECIAL NOTE:**  
THE BUILDING IS FULLY MECHANICALLY VENTILATED

**CLIENT:**  
SKA DEVELOPERS REPRESENTED BY - 1. SRI. SUBISH KUMAR AGARWAL  
2. SRI. SURESH KUMAR AGARWAL  
RESIDENT AT M. L. AGARWAL BROTHERS CHURCH ROAD  
SHOOTAM FOREST BLOCK EAST 59004331 UL SANGER

**SKA Developers**  
S. K. Agarwal  
SANGAR PARTNER

**ARCHITECT:**  
SIGNATURE OF ARCHITECT

**STRUCTURE:**  
SIGNATURE OF STRUCTURE ENGINEER  
**SANJIV J. PAREKH**  
M.E. (STRUCT.), M.E. (CONST. ENG.)  
P.C.E., P.T.E. (P-018202-4)  
P.E. NO. 1044) K.M.C.  
M.C.E. (NR)-27 S.M.C.

**PROJECT:**  
PLAN SHOWING (BASEMENT-1+BASEMENT-2+BASEMENT-3+GROUND+8 STORED MIXED USED OFFICE HOTEL HOTEL SHOPPING MALL COMM. MULTIPLEX) BUILDING AT UTOORAYAN TOWNSHIP, JALPAIGURI.

**DRAWING TITLE:**  
SA-1.10 - SIXTH FLOOR PLAN

**REVISIONS**

REV. NO.	DATE	REMARKS

**DRAWING STATUS:**  
SANCTION

**PROJECT STARTED:** SCALE 1:200

**CHECKED:** ADITYA **DEALT:** PRASANT

**DRAWING NO.:** R2

22 NOV 2022

May be Transferred  
Architect  
Srigiri Mahakuma Panchayat

The Construction of the Building shall be supervised by the Licensed Building Surveyor/Architect signing the plan application. Unless otherwise approved by the Authority the permission shall remain valid for a period of TWO YEARS.  
Registration No. 517. Permission Granted/Permission granted subject to the condition as noted in the ORDER. Building plans also to be approved by the Matigara Panchayat Samity, before the proposed construction undertaken.

1/IDE ORDER NO 179  
DATE 10/3/2023

**APPROVE**  
Executive Officer  
Matigara Panchayat Samity  
P.O. Kadamtala, Dist. Darjeeling

Sub Assistant Engineer (B.P.C.)  
Matigara Development Block  
P.O. Kadamtala, Dt. Darjeeling.

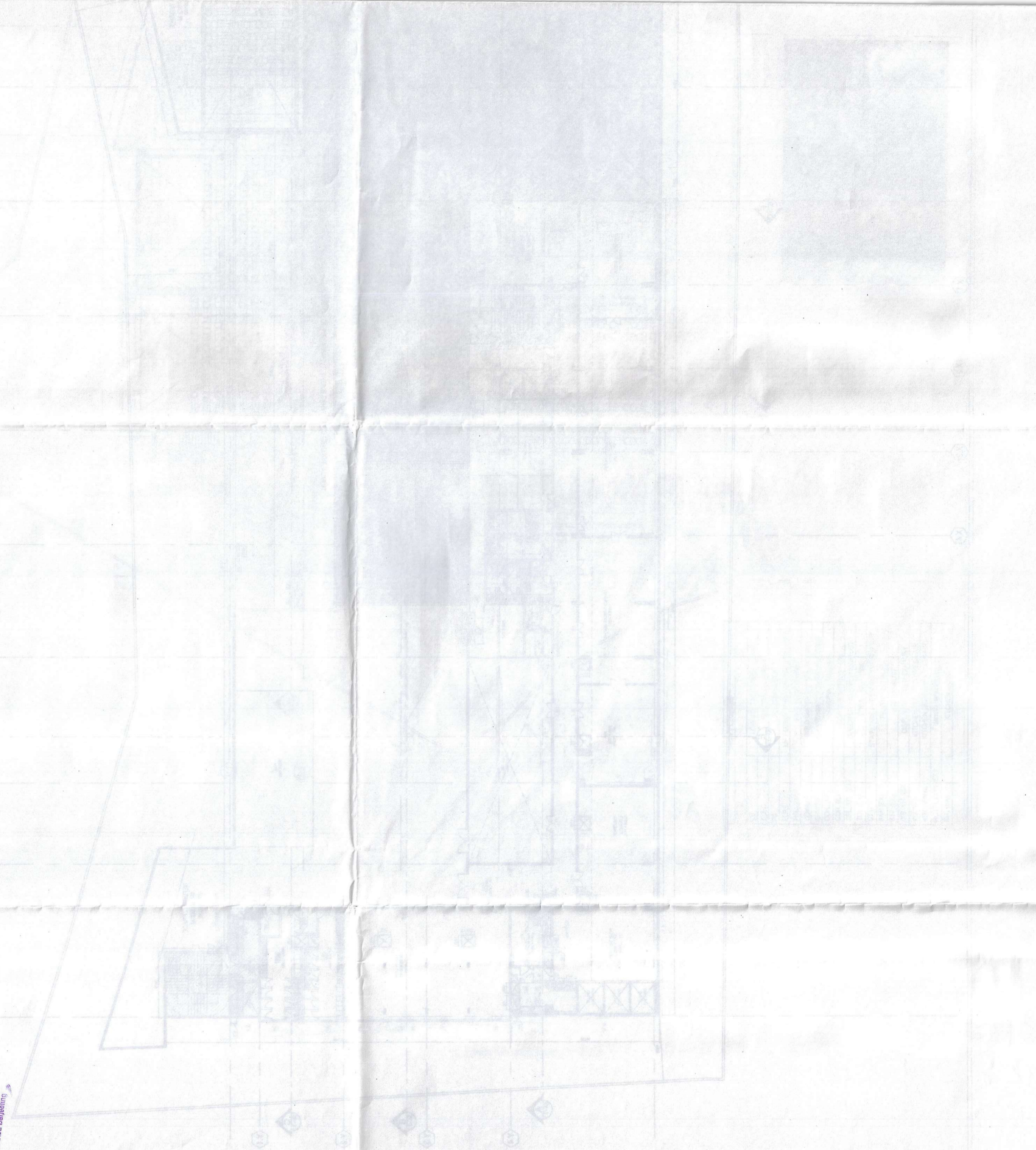

Approved A/S  
Sub Assistant Engineer

Signature  
Sub Assistant Engineer  
Matigara Development Block  
P.O. Kadamtala, Dt. Darjeeling

MAJUR ROOF HTAB - 01/1-AG

NO.	1
DATE	10/3/2023
BY	[Signature]
FOR	[Signature]
REMARKS	